

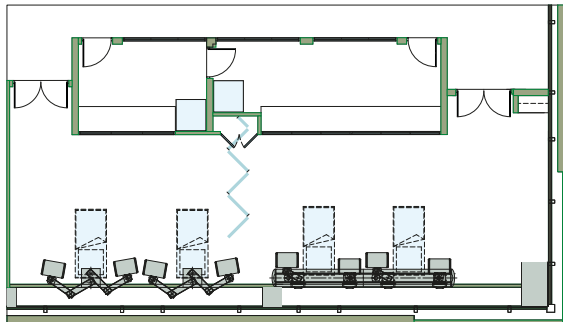

# Intensive Care Unit

## Khalaf Ahmad Al Habtoor Medical Simulation Center

- Venue Type:** Simulated Adult & Pediatric Intensive Care Unit.
- Maximum Capacity:** 6 patient beds
- Size:** 968.75 Square Feet
- Amenities:** The unit can hold up to six patients and includes neonatal, pediatric & adult bays. It hosts a range of adult, pediatric & neonatal simulators of various fidelities & equipment ranging from patient monitoring to crash carts, ventilators & more. It is equipped with Scotia Medical Observation & Training System (SMOTS) and control rooms.
- Parking:** Dubai Health Care City provides a number of paid parking options for delegate guests.



Disclaimer: Layout is for illustrative purpose only